



Provide Comment on LP Structural (cap inc.) Application

Use this form to apply for a Structural Change if requesting an increase in person capacity of your Liquor Primary licensed establishment

The application fee is \$440.

If you leave this page, the information you input will be saved. You can continue later from the dashboard.

BEFORE STARTING THE APPLICATION

The term "local government" is a defined term in our Act and may also include: municipal government, city hall, regional district, local trust, etc. governing the geographic area where your proposed establishment is located. In certain areas, the approving authority may be Indigenous Nation. For the purpose of this guide we will use the short form "LG/IN".

A Structural Change is defined as a change to the existing approved service area(s), including but not limited to:

- a change in the position of a wall or partial height divider (pony wall) or fixed objects (e.g planters, fencing, etc.) used as separation between/within a service area
- new construction
- the removal or addition of permanent display cabinets, stages or dance floors
- a change to the food and liquor service bar location or size
- in the position of access and exit points leading to or from a licensed service area
- the removal of a service area from the liquor licence
- change to capacity (occupant load) of a licensed establishment with or without changes to the licensed service area(s)
- such other construction or changes the general manager considers may affect patron routing, capacity, or the line of sight between a staff control point and the licensed area of the establishment.

[Expand Guide](#)

If an LG/IN is the applicant, the Branch will gather community input and consider the regulatory criteria; the LG/IN is not permitted to conduct public input or provide comments on their own application. This is to prevent conflicts of interest. The applicant must pay any costs incurred to obtain the views of residents.

If you have any questions about this application, contact the Liquor and Cannabis Regulation Branch (LCRB) at LCRBLiquor@gov.bc.ca (<mailto:LCRBLiquor@gov.bc.ca>)

ESTABLISHMENT DETAILS

Establishment Name

Kal Sports Bar (018841)

LIQUOR PRIMARY LOCATION ADDRESS

The establishment is currently located at the following address:

Address

3004 30th Ave

City

VERNON

Province

British Columbia

Postal Code

V1T2B9

Country

Canada

Parcel Identifier (PID)

ESTABLISHMENT CONTACT DETAILS

The phone and email address used to contact your establishment:

Establishment Email

Establishment Phone

(250) 549-1011

APPLICATION DETAILS

Describe in full detail, what the changes are that you want considered: *

We have renovated our golf room to be completely transformed into a modern arcade area. This includes a variety of arcade games catering to all age groups, ensuring an entertaining experience for families and individuals alike. The arcade features interactive video games and classic arcade favorites providing diverse entertainment options. We have added a new dining section with a seating capacity of 60. This area is designed to offer a comfortable and inviting atmosphere for guests to enjoy meals. The dining space includes stylish furnishings, ambient lighting and a versatile layout that can accommodate both small gatherings and larger groups

If you are applying to remove all interior service areas, creating a stand-alone patio, describe the location of the patio in relation to the unlicensed permanent structure. A stand-alone patio must adjoin a permanent structure (affixed to a foundation) which is plumbed and wired, and which the applicant owns or leases.

n/a

Floor Plan

Attach a high-quality copy of the proposed floor plan(s).

The floor plan(s) must be stamped with an occupant load for each proposed service area. The occupant load stamp must be signed and dated by the issuing authority within 1 year prior to the date of submission of this application.

Occupant load is the maximum number of persons (patrons plus staff) permitted in the service area and is generally determined by the Local Government (LG) / Indigenous nation (IN) fire and/or building authorities. If the LG/IN authority will not provide the occupant load, you must request they provide a letter confirming they do not issue occupant load and submit it with this application. The Branch will then accept your floor plan(s) with the occupant load calculation determined, and stamped/dated/signed, by a registered professional architect or engineer.

To avoid unnecessary delays in processing, do not submit this application without a current (within the last 12 months) occupant load stamp.

Plans must show all service areas and the following details:

- labels for each room
- patio(s)
- liquor service bars
- stage
- dance floor
- sound or DJ booth
- stairs, entrances and exits
- kitchen
- washrooms

Plans must also show the physical separation (e.g. pony wall or full height wall) separating the proposed service area(s) from other liquor licences or unlicensed areas. If there is another liquor licence, or another business (such as a retail store) at the same site, provide floor plans showing the other business in relation to the proposed LP establishment.

[Floor Plan_1.pdf \(api/file/216135e1-5e50-ef11-b84c-005056836bf0/download-file/application/Floor Plan_1.pdf?serverRelativeUrl=%2Fadoxio_application%2F110541_216135E15E50EF11B84C005056836BF0%2FFloor%20Plan_1.pdf&documentType=FloorkbPlan\)](#) 3196

SERVICE AREAS

Use the following table to list the service areas and provide their proposed person capacity (patrons and staff combined) for your establishment. Use names like **Patio** to refer to a patio service area.

Note: Proposed capacity cannot exceed occupant load issued by the local authority.

Area No.	Area/Floor Level	Indoor	Patio	Proposed Capacity
1	Main Pub	<input type="checkbox"/>	<input type="checkbox"/>	122
2	Hallway	<input type="checkbox"/>	<input type="checkbox"/>	0
3	South Pub	<input type="checkbox"/>	<input type="checkbox"/>	79
4	Patio	<input type="checkbox"/>	<input type="checkbox"/>	20
5	Family	<input type="checkbox"/>	<input type="checkbox"/>	66
6	Dining	<input type="checkbox"/>	<input type="checkbox"/>	60
Total Requested Capacity:				347

APPLICATION CONTACT DETAILS

Please provide contact information for the contact that the LCRB should communicate with regarding this application.

First Name *

Last Name *

Title/Position

Phone Number (main) *

Email *

By submitting the email address, you agree that the Liquor and Cannabis Regulation Branch can use it to communicate with you about this application.

DECLARATIONS

The application must only be submitted by an individual with the authority to bind the applicant. The branch relies on the applicant to ensure that the individual who submits this application is authorized to do so. Typically, an appropriate individual in a corporation will be a duly authorized signatory who will usually be an officer or, in some cases, a director

Note: A lawyer or consultant, may NOT submit this application on behalf of the applicant.

* I understand and affirm that I am authorized to submit the application

Section 20 (1) of the Liquor Control and Licensing Act states: "The general manager may refuse to issue, renew, transfer or amend a licence if the applicant fails to disclose a material fact required by the application or makes a false or misleading statement in the application."

* I understand and affirm that all of the information provided for this application is true and complete

LOCAL GOVERNMENT/INDIGENOUS NATION CONFIRMATION OF RECEIPT OF APPLICATION

LG/IN

Vernon

Name of Official

Megan Fyfe

Title/Position

Planner II

Phone

(250) 550-3575

Email

mfyfe@vernon.ca

This serves as notice that an application for a structural change to a liquor primary (LP) licence is being made within your community. The Branch requests that you consider this application (application form and floor plan) and provide the Branch with resolution within 90 days of the above received date. Alternatively, LG/IN can delegate staff with the authority to provide comment.

- The applicant will bring their completed Structural Change application form and floor plan to LG/IN.
- If there are any major issues LG/IN may hold off signing the application until the issues are resolved or they have a plan to deal with the issues.
- When LG/IN is comfortable with the application proceeding, LG/IN staff will Accept the application using the button below. LG/IN will keep a copy of the signed application form and all supporting documents.
- The applicant will submit the application to the Branch.

To provide a resolution or comment:

- Gather public input for the community within the immediate vicinity of the establishment.
- Consider these factors which must be taken into account when providing resolution/comment:
 - The location of the establishment.
 - The person capacity and hours of liquor service of the establishment.
- Provide a resolution/comment with comments on:
 - The impact of noise on nearby residents.
 - The impact on the community if the application is approved.
 - The view of residents and a description of the method used to gather views.
 - The LG/IN recommendations (including whether or not the application be approved) and the reasons on which they are based.
- Provide any reports that are referenced in, or used to determine, the resolution/comment.
- If more than 90 days is required, provide a written request for extension to the Branch.
- If LG/IN opts out, or is the applicant, the Branch will gather public input and contact LG/IN staff for information to assist the Branch in considering the regulatory criteria.

If you have any questions, or the establishment is located on Treaty First Nation land, please call the Branch toll-free at 1-866-209-2111.

TO UPLOAD DOCUMENTS, DRAG FILES HERE OR [BROWSE](#).
FILES MUST BE IN PDF, JPEG, OR PNG FORMAT.
MAX FILE SIZE: 25MB.

Opt Out of Comment

Reject Application

Accept Application

BUSINESS NAME: The Kal Sports Bar
 ADDRESS: 3004 30 Ave
 OCCUPANT LOAD: Dining = 60 People
 REVIEWED BY: [Signature]
 DATE: July 8, 2024
 CITY OF VERNON

BUSINESS NAME: The Kal Sports Bar
 ADDRESS: 3004 30 Ave
 OCCUPANT LOAD: Family = 66 People
 REVIEWED BY: [Signature]
 DATE: July 8, 2024
 CITY OF VERNON

ICE PERMITTING
 LOT #4
 PLAT #37
 BLOCK #8
 SEC #4
 T.P. #9 DDD

OVERALL SEATING

MAIN PUB AREA	1762 SQ FT	SEATS 122
SEASONAL PATIO	330 SQ FT	SEATS 20
FAMILY ROOM	665 SQ FT	SEATS 66
BBQ ROOM	732 SQ FT	SEATS 60
SOUTH PUB AREA + BAR	1405 SQ FT	SEATS 79

BUSINESS NAME: The Kal Sports Bar
 ADDRESS: 3004 30 Ave
 OCCUPANT LOAD: Main Pub = 122 People
 REVIEWED BY: [Signature]
 DATE: July 8, 2024
 CITY OF VERNON

BUSINESS NAME: The Kal Sports Bar
 ADDRESS: 3004 30 Ave
 OCCUPANT LOAD: Hallway = 0 People
 REVIEWED BY: [Signature]
 DATE: July 8, 2024
 CITY OF VERNON

BUSINESS NAME: The Kal Sports Bar
 ADDRESS: 3004 30 Ave
 OCCUPANT LOAD: South Pub = 79 People
 REVIEWED BY: [Signature]
 DATE: July 8, 2024
 CITY OF VERNON

BUSINESS NAME: The Kal Sports Bar
 ADDRESS: 3004 30 Ave
 OCCUPANT LOAD: Patio = 20 People
 REVIEWED BY: [Signature]
 DATE: July 8, 2024
 CITY OF VERNON

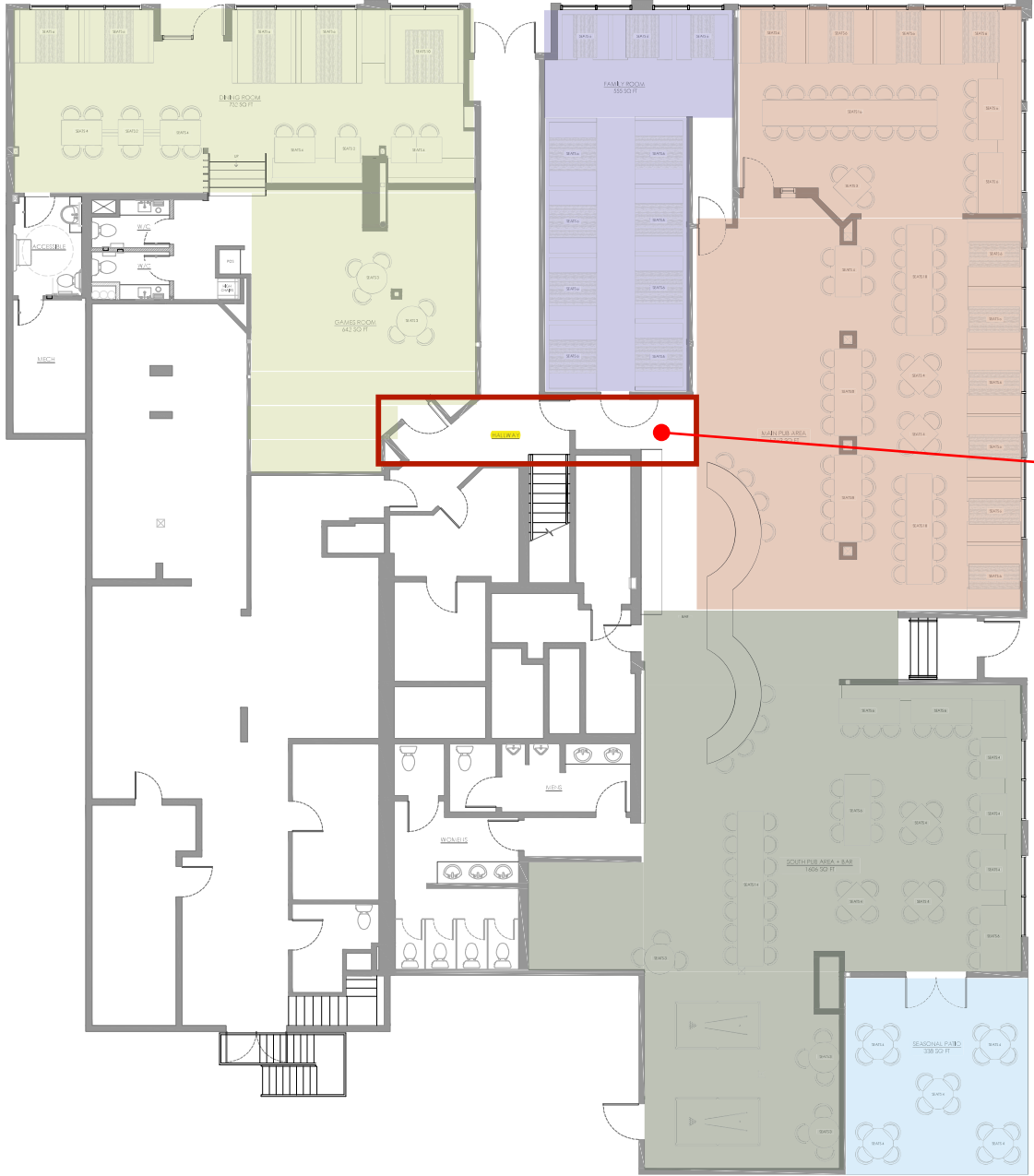

FLOOR PLAN
 1/8" = 1'-0"



LIQUOR LICENSE

BUSINESS: KAL SPORTS BAR
 ADDRESS: 3004 30 AVE VERNON BC V1T 2B9
 DATE: 2024-07-05
 CONTACT: LACY DONALD 250.549.1011